

SEE KEY MAP 4

KEY MAP

- 10 PLATE NUMBER
- 107 BLOCK NUMBER
- LOT-LINE
- ARTIFICIAL-BLOCK-LIMIT-LINE
- (MATCH LINE) MATCH LINE
- PLATE DELINEATION LINE
- KEY MAP DELINEATION LINE
- MUNICIPAL BOUNDARY LINE
- COUNTY BOUNDARY LINE
- WATERWAY LINES
- ASSESSMENT LINE
- TIDELANDS LINE
- W.L.A. WETLAND AREA - W.L.A.
- F.H.A. FLOOD HAZARD AREA - F.H.A.
- PIERHEAD LINE PIERHEAD OR BULKHEAD LINE
- BULKHEAD LINE PIERHEAD OR BULKHEAD LINE (BLOCK LIMIT LINE)

SEE KEY MAP 4

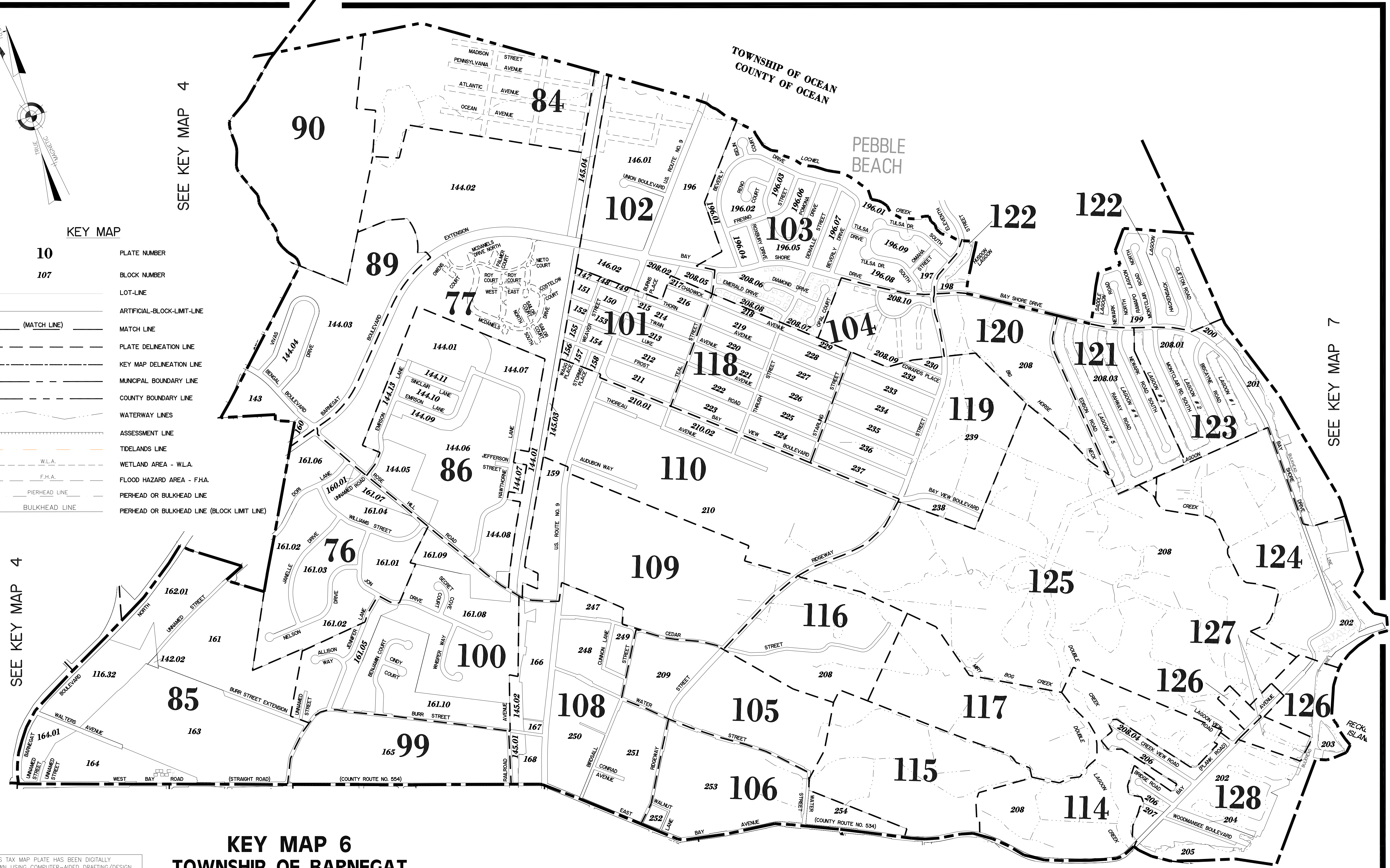

SEE KEY MAP 7

**KEY MAP 6**  
**TOWNSHIP OF BARNEGAT**

OCEAN COUNTY NEW JERSEY  
 SCALE: 1" = 500' DATE: 11-14-2003

CRAIG F. REMINGTON LAND SURVEYOR LIC. NO. 23924



REMINGTON, VERNICK & VENA ENGINEERS  
 24 GA 28003300  
 9 ALLEN STREET, TOMS RIVER, N.J. 08753  
 (732) 286-9220, FAX (732) 505-8446  
 WEB SITE ADDRESS: WWW.RVE.COM

SEE KEY MAP 5

"THIS TAX MAP PLATE HAS BEEN DIGITALLY DRAWN USING COMPUTER-AIDED DRAFTING/DESIGN (CADD), AND COORDINATE GEOMETRY (COGO). IT IS BASED ON THE ORIGINAL DIGITALLY DRAWN TAX MAP PLATE BEARING THE OFFICIAL NEW JERSEY DIVISION OF TAXATION APPROVAL STAMP WITH APPROVAL DATE (7-31-2006) SERIAL NUMBER (896) AND SIGNATURES OF SIGNERS' JAMES J. COLL, CHIEF, LOCAL ASSESSMENT, SANTO C. DIDONATO, SUPERVISING FIELD REPRESENTATIVE. THIS TAX MAP PLATE HAS BEEN DIGITALLY UPDATED TO REFLECT CONDITIONS AS OF 8-27-2013. THE ORIGINAL DIGITALLY DRAWN TAX MAP PLATE WITH THE OFFICIAL APPROVAL STAMP IS ON FILE WITH THE TOWNSHIP OF BARNEGAT ENGINEER."